



## EAST STATE STREET TIF INTERESTED PARTIES REGISTRATION FORM

The City of Geneva Economic Development Department maintains a list of interested parties for the East State Street TIF District. This form allows the interested parties to receive updates and information on the activity in the TIF District. The TIF boundary is generally described as commercial properties from School Street to Longview Drive along State Street/ Route 38(see map on back).

**Registration for City Residents:** If you are a City of Geneva resident and would like to register on the Interested Parties Registry for the East State Street Tax Increment Financing (TIF) District, please complete Part A of this form.

**Registration for Organizations:** If your organization is active in the City of Geneva and would like to register on the Interested Parties Registry for the East State Street Tax Increment Financing (TIF) District, please complete Part B of this form.

### **PART A: REGISTRATION FOR CITY RESIDENTS (Please Print)**

Name \_\_\_\_\_  
Street Address \_\_\_\_\_  
Zip Code \_\_\_\_\_ Telephone \_\_\_\_\_  
Email \_\_\_\_\_

Are you a resident?                      Yes                      No

Are you a property owner in the district?                      Yes                      No

### **PART B: REGISTRATION FOR ORGANIZATIONS**

Organization Name \_\_\_\_\_  
Contact Name \_\_\_\_\_  
Street Address \_\_\_\_\_  
City \_\_\_\_\_ State \_\_\_\_\_ Zip Code \_\_\_\_\_  
Telephone \_\_\_\_\_ Fax Number \_\_\_\_\_ Email \_\_\_\_\_  
Website \_\_\_\_\_

### **Please return form to:**

City of Geneva  
Economic Development Department  
22 South First Street  
Geneva, IL 60134

Signature/Title \_\_\_\_\_ Date \_\_\_\_\_



# EAST SIDE TIF DISTRICT

## Geneva, Illinois

### Commercial Redevelopment Opportunity



- A- Existing used car lot 94,000 s.f.
- B- Existing mulch/firewood sales 23,000 s.f.
- C- Existing strip center 39,000 s.f.
- D- Existing auto repair shop 29,000 s.f.
- E- Varied commercial/vacant uses 124,000 s.f.

### New Commercial Buildings



- 1- Kakolires Building 5,000 s.f.
- 2- Hart Chiropractor Bldg 3,000 s.f.
- 3- Dairy Queen 1,100 s.f.
- 4- Valley Animal Hospital 4,000 s.f.
- 5- CVS/pharmacy 10,800 s.f.

### Existing Building Improvement/Addition

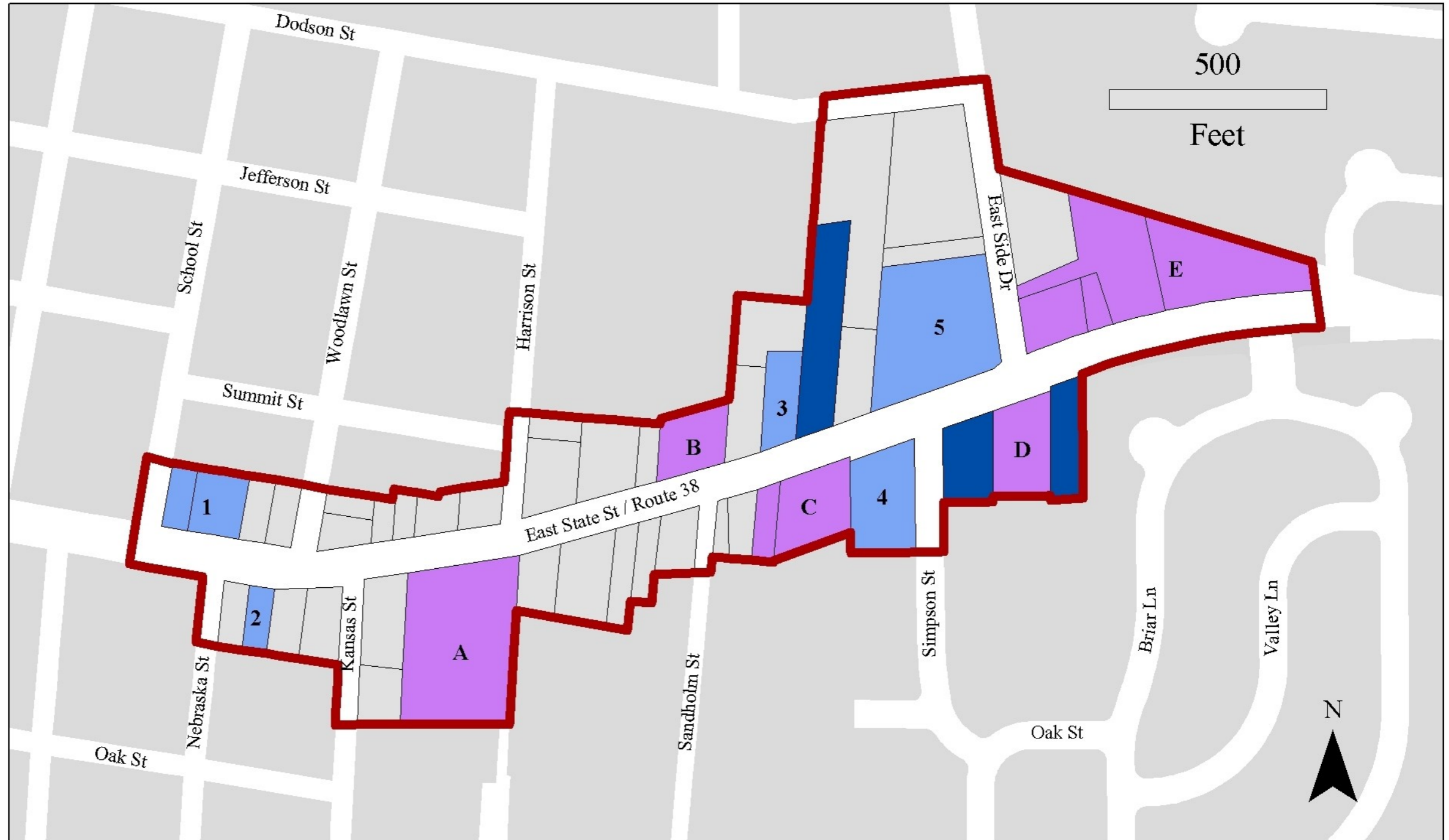

**GENERATED BY:**  
 City of Geneva  
 Information Systems Division  
 April 2005  
 Original base maps provided via  
 intergovernmental agreement with  
 Kane County GIS-Technologies.