

3/14/2023 9:42 AM - Z:\Projects\2016\828.00-IL\312 - ENGINEERING CAD FILES\FINAL\EXHIBITS\828.00-IL TRUCK TURNING Exhibit_recover_recover.dwg

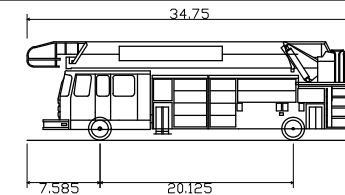

St. Charles Fire Truck 101	
Overall Length	34.750ft
Overall Width	10.670ft
Overall Body Height	10.226ft
Min Body Ground Clearance	0.657ft
Track Width	6.827ft
Lock-to-lock time	5.00s
Curb to Curb Turning Radius	34.750ft

STORMWATER MANAGEMENT AREA
 HWL=764.84
 NWL=759.00
 REQ. VOL.=6.939 AC-FT
 PROV. VOL.=7.184 AC-FT
 REQ. VOL. CONTROL=0.674 AC-FT
 PROV. VOL. CONTROL=0.698 AC-FT

PROPOSED BUILDING
 156,000 SF
 FF=775.00



SCALE: 1"=80'

3/14/2023 9:43 AM - Z:\Projects\2016\828.00-IL\312 - ENGINEERING CAD FILES\FINAL\EXHIBITS\828.00-IL TRUCK TURNING Exhibit_recover_recover.dwg

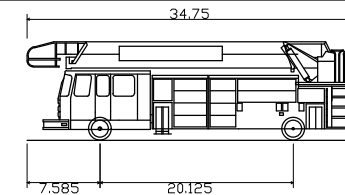

St. Charles Fire Truck 101	
Overall Length	34.750ft
Overall Width	10.670ft
Overall Body Height	10.226ft
Min Body Ground Clearance	0.657ft
Track Width	6.827ft
Lock-to-lock time	5.00s
Curb to Curb Turning Radius	34.750ft

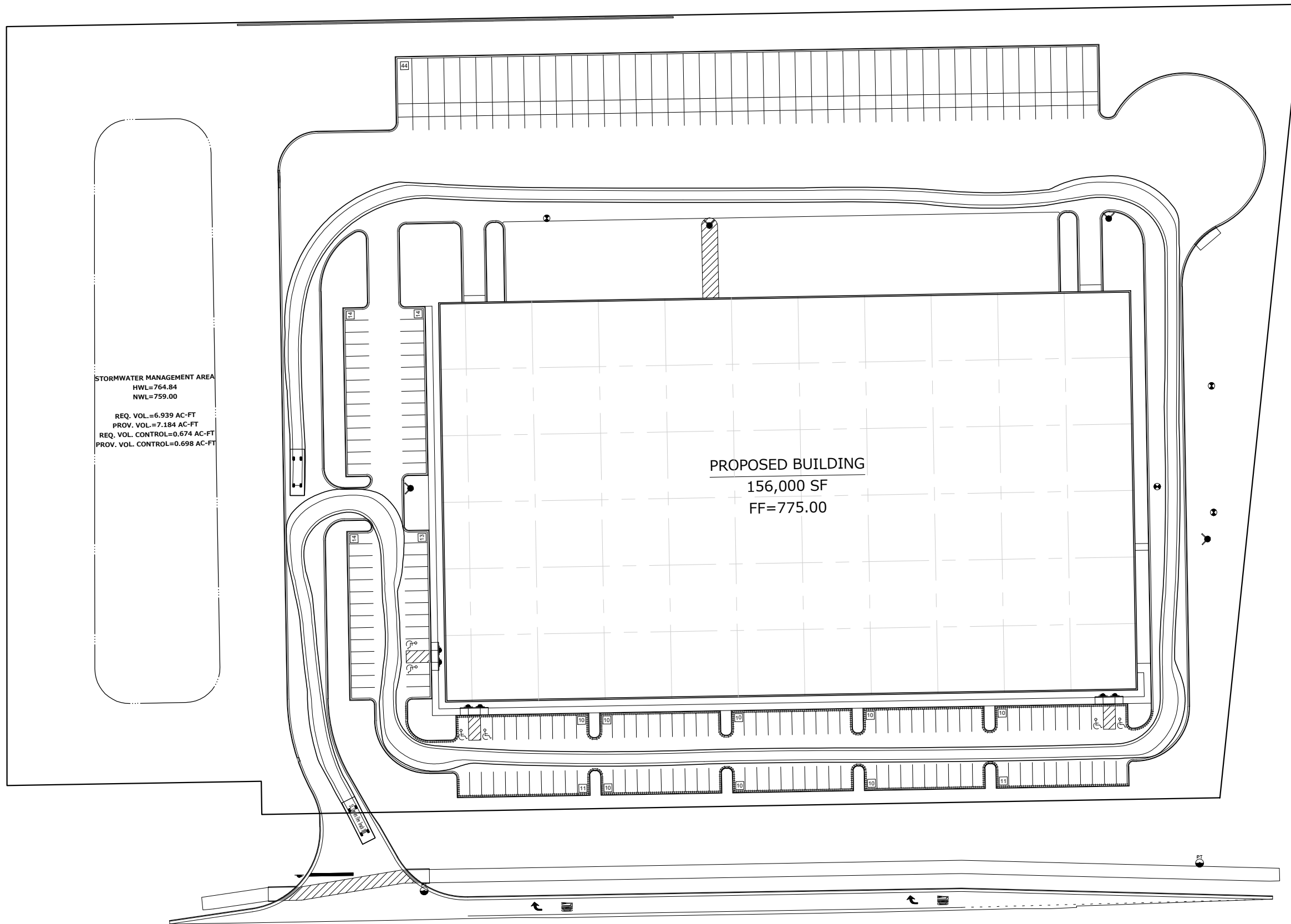

STORMWATER MANAGEMENT AREA
 HWL=764.84
 NWL=759.00
 REQ. VOL.=6.939 AC-FT
 PROV. VOL.=7.184 AC-FT
 REQ. VOL. CONTROL=0.674 AC-FT
 PROV. VOL. CONTROL=0.698 AC-FT

PROPOSED BUILDING
 156,000 SF
 FF=775.00



SCALE: 1"=80'